



Instruction Manual

Splash & Spin Bathtime Flowers



VTech understands that a child's needs and abilities change as they grow and with that in mind we develop our toys to teach and entertain at just the right level...

vtech Baby

Toys that will stimulate their interest in different textures, sounds and colours

I am...

...responding to colours, sounds and textures

...understanding cause and effect

...learning to touch, reach, grasp, sit-up, crawl and toddle

Birth-36 months



Pre-School

Interactive toys to develop their imagination and encourage language development

I want...

...to get ready for school by starting to learn the alphabet and counting

...my learning to be as fun, easy and exciting as can be

...to show my creativity with drawing and music so my whole brain develops

3-6 years



Electronic Learning Computers

Cool, aspirational and inspiring computers for curriculum related learning

I need...

...challenging activities that can keep pace with my growing mind

...intelligent technology that adapts to my level of learning

...National Curriculum based content to support what I'm learning at school

4-10 years



To learn more about this and other VTech® products, visit www.vtech.co.uk

INTRODUCTION

Thank you for purchasing the **Splash & Spin Bathtime Flowers!**

Get ready for trunkful's of fun with the **Spin & Splash Bathtime Flowers!** Use the cute elephant watering can to pour water over the textured flowers and watch them spin! Twist the spout to change the water spray pattern for fun visual effects. Bathtime has never been so fun!



3 Spinning Flowers

Elephant Watering Can

INCLUDED IN THE PACKAGE

- Elephant Watering Can
- 3 Spinning Flowers
- Quick Start Guide

WARNING

All packing materials such as tape, plastic sheets, packaging locks, removable tags, cable ties, cords and packaging screws are not part of this toy, and should be discarded for your child's safety.

NOTE

Please save this Instruction Manual as it contains important information.

WARNINGS:

- This toy cannot be used in salt water.
- After using this toy, do not leave it in the water for a long time.
- This is not a lifesaving device. Do not leave your child unattended while in water.
- Never leave a child unattended or with an older child in the bathroom or in the bath, not even for one minute.
- Always check with a thermometer the temperature of the water coming from the tap before sitting your child in the bath. Children have very sensitive skin and can easily get burnt if the water is too hot.
- Only use this unit in water between 10 and 45 degrees centigrade.

NOTE

After playtime, empty all water from the Elephant Watering Can to help prevent mold from forming.

MOUNTING INSTRUCTIONS

With the **VTech® Splash & Spin Bathtime Flowers**, safety comes first. To ensure your child's safety, adult assembly is required.

1. Choose a surface on the tiles surrounding the bath where the suction cup support unit can be mounted securely. The area should be clean and dry before suctioning the unit to the tiles. For better suction, we suggest wetting the suction cup before attaching it to the tiles. Press the suction cup onto the tiles to secure the flowers. Once the flowers are attached to the wall, test the strength of the suction by pulling gently on the unit. The suction cup may not stick properly to textured tiles. We recommend that the unit be removed from the tiles after each use as the strength of the suction cup cannot support prolonged use.
2. To remove the unit from the tiles, pull the tab on the suction cup and pull the Flowers gently.

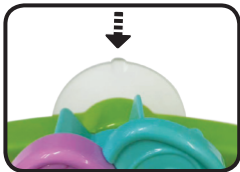
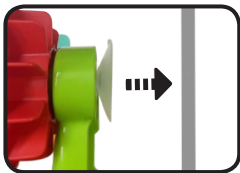

NOTE

Do not place the Spinning Flowers too high, as this could cause them to fall and potentially injure children.

ACTIVITIES

1. Adjustable Spout

Twist the spout to adjust the water spray patterns.



2. Water the Flowers

Fill the elephant watering can with water, then, tip and pour onto the flowers and watch them spin like magic!



CARE & MAINTENANCE

1. Keep the bath toys clean by wiping them with a slightly damp cloth.
2. Keep the bath toys out of direct sunlight and away from any direct heat sources.
3. Do not drop the bath toys on a hard surface.

CONSUMER SERVICES

Creating and developing **VTech®** products is accompanied by a responsibility that we at **VTech®** take very seriously. We make every effort to ensure the accuracy of the information, which forms the value of our products. However, errors sometimes can occur. It is important for you to know that we stand behind our products and encourage you to call our Consumer Services Department with any problems and/or suggestions that you might have. A service representative will be happy to help you.

UK Customers:

Phone: 0330 678 0149 (from UK) or +44 330 678 0149 (outside UK)
Website: www.vtech.co.uk/support

Australian Customers:

Phone: 1800 862 155
Website: support.vtech.com.au

NZ Customers:

Phone: 0800 400 785
Website: support.vtech.com.au

PRODUCT WARRANTY/ CONSUMER GUARANTEES

UK Customers:

Read our complete warranty policy online at vtech.co.uk/warranty.

Australian Customers:

**VTECH ELECTRONICS (AUSTRALIA) PTY LIMITED –
CONSUMER GUARANTEES**

Under the Australian Consumer Law, a number of consumer guarantees apply to goods and services supplied by VTech Electronics (Australia) Pty Limited. Please refer to vtech.com.au/consumerguarantees for further information.

**Visit our website for more
information about our products,
downloads, resources and more.**

www.vtech.co.uk
www.vtech.com.au

